

3 X $\frac{1}{4}$ " CLEAR MOUNTING
HOLES EQUALLY SPACED
1-1/2" DIA.

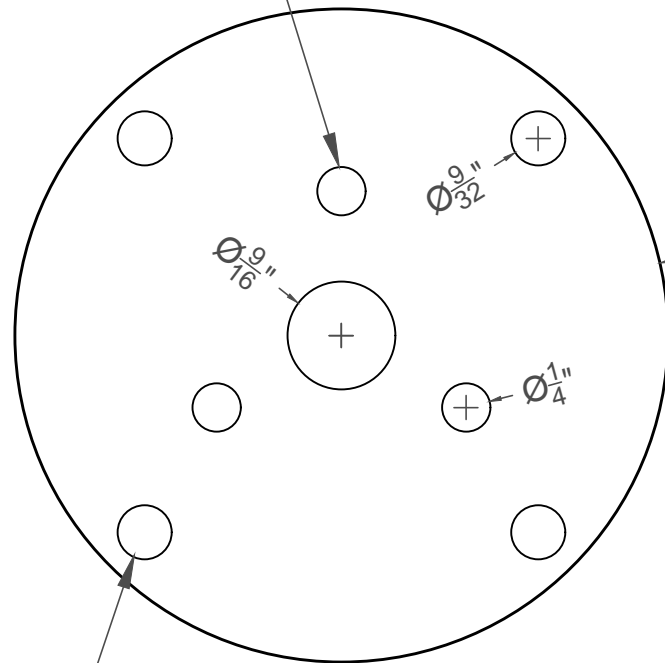

$\varnothing 3\frac{3}{8}$ " X 12 GA. MILD STEEL
RUB BLOCK PLATE #RBP1

4 X $\frac{1}{4}$ " CLEAR FIXING
HOLES EQUALLY
SPACED $2\frac{29}{32}$ " DIA.



www.go4b.com/usa

625 Erie Avenue - Morton, IL 61550 USA
Tel: 309-698-5611 Fax: 309-698-5615

CUSTOMER:

DESCRIPTION:
RBP1 RUB BLOCK PLATE

SO # PO # SCALE:

FULL

DRAWN: CM CHECKED: BK DRAWING # REV:

DATE: 10/14/2016 DATE: 10/14/2016 1 OF 1 0

CHANGE NOTE	REV	DATE	DRAWN	CHECK	DESCRIPTION