

AA Nylon Elevator Bucket

“AA” Style Industrial Duty Toughened Nylon Elevator Bucket

APPLICATION

Heavy duty toughened injection molded nylon bucket. Designed to handle sticky, light industrial, and heavy industrial materials such as: sand, aggregate, cement, coal, sugar, fertilizer, salt or glass

FEATURES

- ▶ Made from toughened nylon, high-density polyethylene (HDP) or urethane
- ▶ Available in food grade HDP or nylon to meet USDA/FDA standards
- ▶ Injection molded for uniformity
- ▶ Corrosion and abrasion resistant
- ▶ Maximum operating temperatures:
Continuous - Nylon 212°F, HDP 158°F, Polyethylene 140°F
Peak - Nylon 248°F, HDP 176°F, Polyethylene 158°F



ACCESSORIES

- ▶ Bolts - Norway, Fanged, Euro or Easifit
- ▶ Washers & Nuts
- ▶ Belting - Rubber, PVC, Steel Web
- ▶ Belt Fasteners

FREE

Elevator & Conveyor Engineering Design Service

Take advantage of 4B's free, guaranteed worldwide technical support service from a team of material handling engineers specializing in the design and upgrade of bucket elevators and conveyors.

Whether you want a new elevator design, or just want to increase the capacity and performance of your existing elevator, our engineers can help.

AA Nylon Elevator Bucket

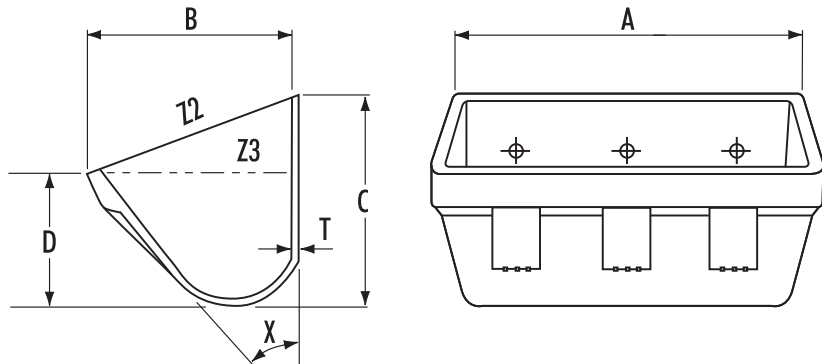
TECHNOLOGY · INNOVATION · QUALITY · VALUE
TECHNICAL SPECIFICATIONS
AA Nylon Elevator Bucket

Nominal Size	Part #		Dimensions (Inches)			Capacity (in ³)		Nylon
	Nylon	HDP	Length A	Projection B	Back Depth C	Gross	Water Level	Weight (Lbs.)
4 x 3	AN043	AP043	4-1/4	3-1/8	3-1/8	15.9	13.4	0.25
5 x 4	AN054	AP054	5-1/4	4-1/8	4-1/8	45.2	34.8	0.52
6 x 4	AN064	AP064	6-1/4	4-1/8	4-1/8	54.3	41.5	0.59
7 x 4	AN074	AP074	7-1/4	4-1/8	4-1/8	65.3	51.3	0.66
7 x 5	AN075	AP075	7-1/8	5-1/8	5-1/4	94.6	76.6	0.97
8 x 5	AN085	AP085	8-1/8	5-1/8	5-1/4	111.7	89.7	1.10
9 x 5	AN095	AP095	9-1/8	5-1/8	5-1/4	122.0	101.3	1.18
15 x 5	AN155	-----	15-3/4	5-1/2	5-1/2	209.1	140.0	2.78
19 x 5	AN195	-----	19-3/4	5-1/4	5	228.1	146.9	3.20
9 x 6	AN096	AP096	9-3/8	6-1/8	6-1/8	170.9	132.4	1.48
10 x 6	AN106	AP106	10-3/8	6-1/8	6-1/8	191.6	148.3	1.61
11 x 6	AN116	AP116	11-3/8	6-1/8	6-1/8	209.3	163.5	1.70
12 x 6	AN126	AP126	12-3/8	6-1/8	6-1/8	248.1	188.0	2.10
12 x 7	AN127	AP127	12-3/8	7-1/8	7-1/8	320.4	244.1	2.50
14 x 7	AN147	AP147	14-3/8	7-1/8	7-1/8	384.4	298.4	2.75
14 x 8	AN148	AP148	14-3/8	8-1/8	8-1/8	463.8	351.5	4.28
16 x 8	AN168	AP168	16-3/8	8-1/8	8-1/8	540.0	406.4	4.63
18 x 8	AN188	AP188	18-1/8	8-1/8	8-1/8	619.4	467.4	5.24
24 x 8	AN248	-----	24	8	8-1/2	623.8	445.8	9.06
18 x 10	AN1810	AP1810	18-1/2	10-1/8	10-1/8	915.0	690.0	8.50
24 x 13	AN2413	-----	24	12-1/4	12-3/4	1728.0	946.4	18.58

Material: Injection Molded Nylon, Urethane or High Density Polyethylene (HDP)

Bolt Holes: Drilled to customer's requirements

Venting: Mounting holes and venting to your specifications

 Please refer to instruction manual for correct installation.
 Information subject to change or correction. March 2008.